



Grade U2 - U3 Stud Link Anchor Chain - Chain Swivel

Chain Swivels are associated fittings for use within stud link anchor chain assemblies, such as swivel forerunner, for connecting the stud link anchor chain to an anchor or in a navigation buoy mooring bridle system. These are index sized to be compatible with each size of stud link anchor chain. The material and heat treatment should be the same as that of the stud link anchor chain that they are fitted to.

Classification: L.R.S; B.V; A.B.S. (other classification available upon request).

Chain diameter range: 14mm – 60mm, generally available in black bitumen coating, although hot dip galvanized finish is also available (larger sizes available upon request).

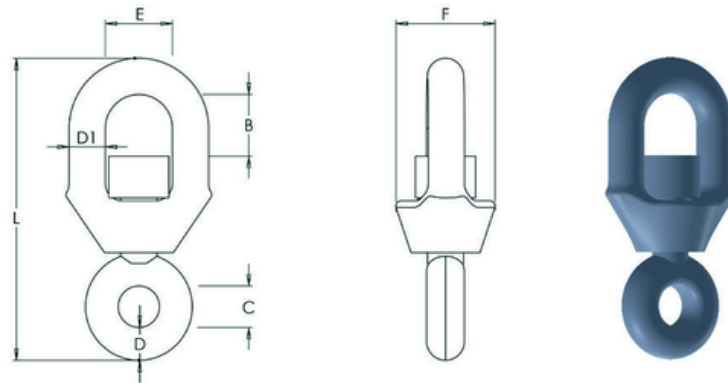

Part Code	Chain Size (mm)	B (mm)	C (mm)	D (mm)	D1 (mm)	E (mm)	F (mm)	L (mm)	Weight (Kg)
231.09.22	22	36	31	24	26	51	75	213	3.55
231.09.24	24	40	34	26	29	56	82	233	4.42
231.09.26	26	43	36	29	31	60	88	252	5.50
231.09.28	28	46	39	31	34	65	95	272	7.80
231.09.30	30	50	42	33	36	69	102	291	8.60
231.09.32	32	53	45	35	38	74	109	310	10.30
231.09.34	34	56	48	37	41	78	116	330	12.90
231.09.36	36	59	50	40	43	83	122	349	15.30
231.09.38	38	63	53	42	46	87	129	369	17.50
231.09.40	40	66	56	44	48	100	136	388	19.90